

Mounting of the lock Side or Rear Doors Vans (ref 1834)



Warning : Assembly Photos at the Back of a Side Door...to the right of the vehicle
If Mounting Rear Door or Other Door See NOTE*



1 - Check the Misalignment, which must not exceed 0.5 mm.
If Upper Adjust the Door.

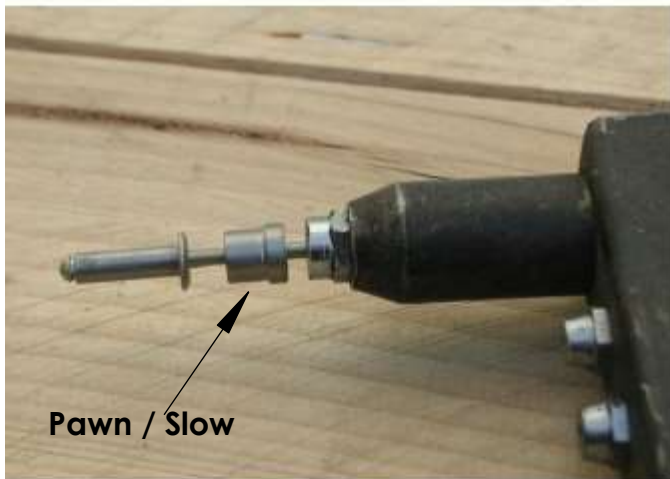

Pawn / Slow

3 - Counter-drill the Hole N° 2 and place the Rivet with the Slow down and then the same for Hole N° 3.

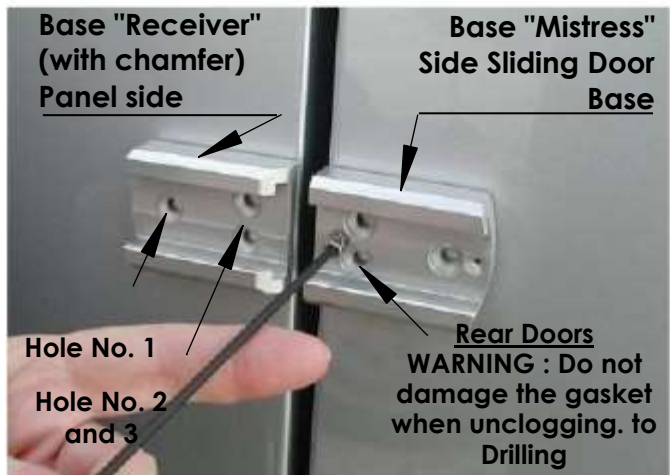

Base "Receiver" (with chamfer) Panel side

Base "Mistress" Side Sliding Door Base

Hole No. 1
Hole No. 2 and 3

Rear Doors
WARNING : Do not damage the gasket when unclugging. to Drilling

5 - Drill & Place first the Middle Rivet (1) then Check the Alignment with the Slider (Rotate slightly if necessary) and Drill & Place the other 2 Rivets (2 & 3) after handing over the Drilling Template. Block the 2 Screws on the Master Base.

NOTA: Ex: Rear Door Mounting DUCATO Mount the Master Base (without chamfer) on the Left. So You will not be Hindered by the original Door Handle to put it on, in the final, the Slider. (Stage 7) Sufficient clearance is essential

**For Your Safety,
Always Drive
Locked Cylinder**



Base "Mistress" Sliding Door Side

Grease Every Hole in the Bodywork

Hole No. 1

Hole No. 2 and 3

2 - Position the "Mistress" Base at the Edge of the Door. (The one who will receive the Screws) Mark out, Drill to Ø 5 mm and Place a Rivet on Hole

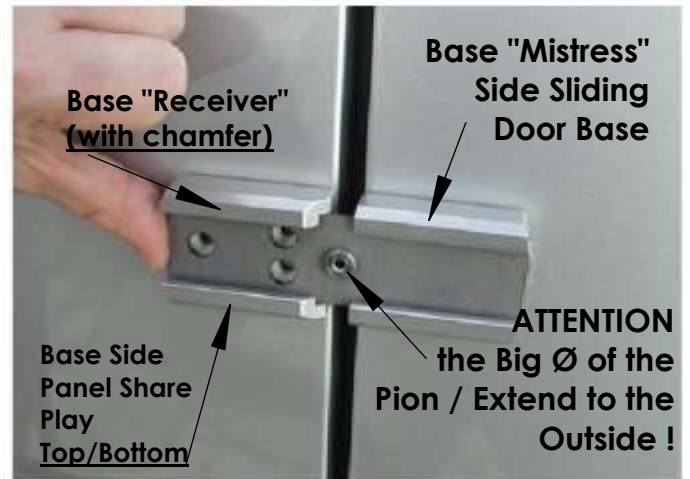

Base "Receiver" (with chamfer)

Base "Mistress" Side Sliding Door Base

Base Side Panel Share Play Top/Bottom

ATTENTION
the Big Ø of the Pion / Extend to the Outside !

4 - Present the "Receiver" Base with the "Receiver" Template. Drill hole threaded in their slides and position the Pawn / Slow down in the center hole.



6 - Mount and Lock your Lock



7 - Put on the Slider and Mount the Last Screw

8 - Your Lock is Ready to work.

Find this Video Montage on www.imc-creations.fr